

# MANTA®

## Piston Distributor for Oil and Fluid Grease

### Function

Piston distributors meter out and distribute the oil delivered by an intermittently actuated pump. The quantities of oil for the individual lube points are determined by exchangeable metering nipples. The metered amount is indicated on the individual nipples. The amount needed to cover the total oil demand can then be further regulated via the lubricating frequency. To meet the required quantities and comply with spatial constraints it is possible to choose among four distributor groups that differ in terms of their metering ranges and sizes. The functional principle of the groups is the same, but there are differences in design. Different distributor groups can be used in one installation.



Distributor for Oil group	Quantity cm <sup>3</sup>
3200	0,01 0,03 0,06 0,1 0,16
3400	0,01 0,03 0,06 0,1 0,16
3500	0,1 0,2 0,4 0,6
3900	0,2 0,4 0,6 1,0 1,5
Distributor for fluid grease group	Quantity cm <sup>3</sup>
3410	0,01 0,03 0,06 0,1
3510	0,1 0,2 0,3
3910	0,1 0,2 0,3
3210	0,01 0,03 0,06 0,1 0,2 0,3

**MANTA<sup>®</sup>**

**Piston distributor for oil**

group 3200 0,01 – 0,16 cm<sup>3</sup>

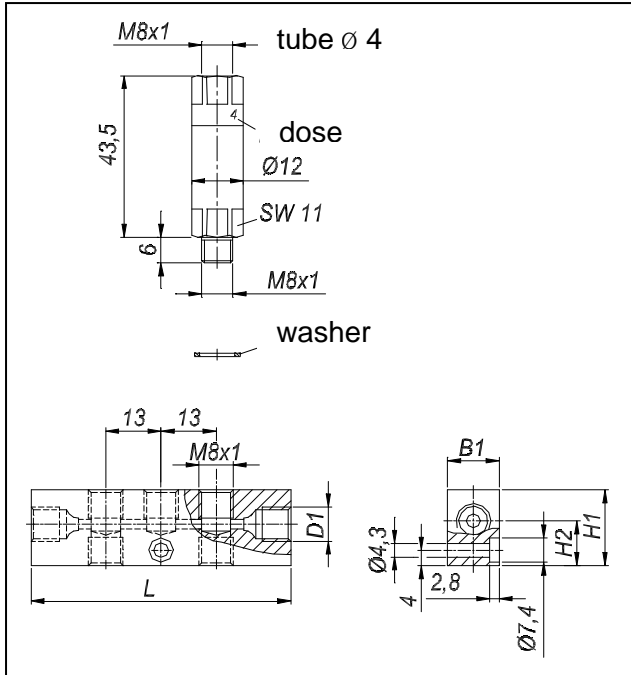

Number of lubrication points	thread D1	Main line Ø	B1	H1	H2	L
2	M10x1	6	13	17	10,5	52
3						65
5						65
2	M14x1,5	8	18	20	11	61
3						74
5						74

Manifold

Order-No	Quantity cm <sup>3</sup>	marking on the metering nipple
6311	0,01	1
6312	0,03	2
6313	0,06	3
6314	0,10	4
6315	0,16	5

Piston distributor

Order key:

**3200-X-XXXXX-X**

Number of outlets:



Quantity<sup>2)</sup>:

- 0 – 0 cm<sup>3</sup> - outlet closed
- 1 – 0,01 cm<sup>3</sup>
- 2 – 0,03 cm<sup>3</sup>
- 3 – 0,06 cm<sup>3</sup>
- 4 – 0,10 cm<sup>3</sup>
- 5 – 0,16 cm<sup>3</sup>

<sup>2)</sup>marking on the metering nipple

mounting thread D1

B – M10x1

C – M14x1,5

Order example:

Distributor group: **3200**

with 3 outlets key: **3**

marking from the right to the left:

0,06 - 0,10 - 0,03 cm<sup>3</sup>

Order key: **3 4 2**

Mounting thread of the distributor last M10x1

Order key: **B**

Order key: **3200-3-342-B**

**Specifications**

- operating pressure: 10 – 45 bar
- medium: oil
- viscosity: 32 to 2000 mm<sup>2</sup>/s
- temperature range: +0°C to + 70°C
- perm. residual pressure: max. 1,5 bar

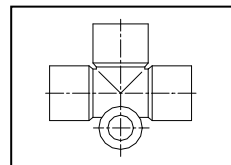

For one lube point the metering unit can only be used with a tee piece.

# MANTA®

## Piston Distributor for Oil

group 3400 0,01 – 0,16 cm<sup>3</sup>

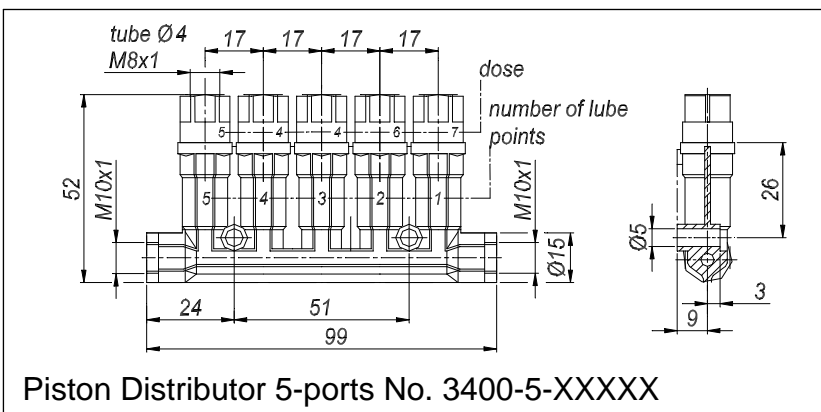
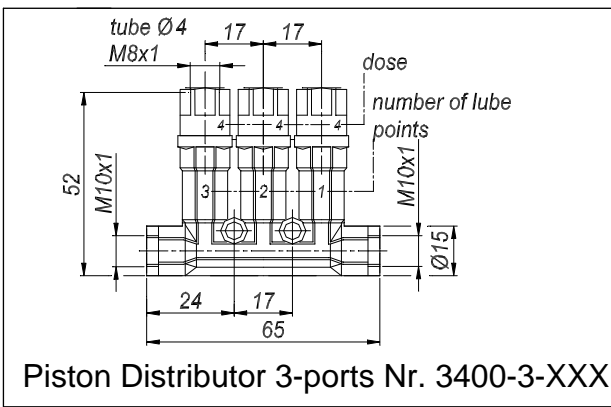
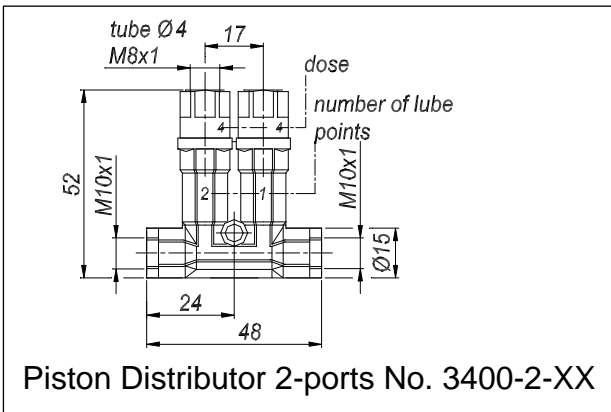
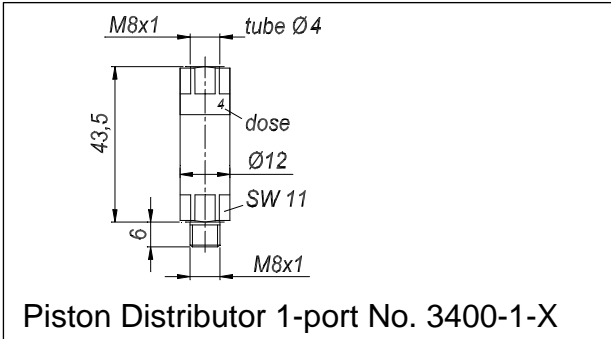

### Order key:

**3400-X-XXXXX**

Number of outlets :

- 1
- 2
- 3
- 5

5 4 3 2 1

Quantity<sup>2)</sup>:

0 – 0 cm<sup>3</sup> - outlet closed

1 – 0,01 cm<sup>3</sup>

2 – 0,03 cm<sup>3</sup>

3 – 0,06 cm<sup>3</sup>

4 – 0,10 cm<sup>3</sup>

5 – 0,16 cm<sup>3</sup>

<sup>2)</sup> marking on the metering nipple

### Order example:

Distributor group: **3400**

with 3 outlets key: **3**

marking from the right to the left:

0,06 - 0,10 - 0,03 cm<sup>3</sup>

Order key:

**3 4 2**

### Order key: 3400-3-342

### Specifications

operating pressure: 10 – 45 bar

medium: oil

viscosity: 32 to 2000 mm<sup>2</sup>/s

temperature range: +0°C to + 70°C

perm. residual pressure: max. 1,5 bar

**MANTA®**

**Piston distributor for oil**  
group 3500 0,10 – 0,60 cm<sup>3</sup>

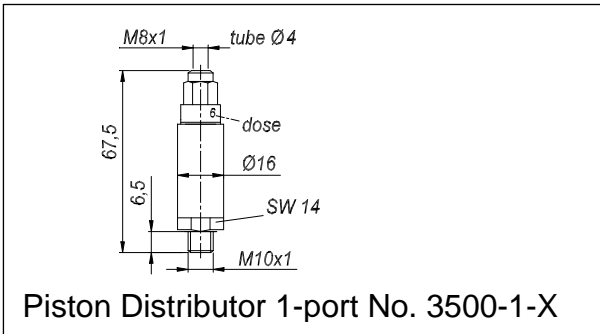

Piston Distributor 1-port No. 3500-1-X

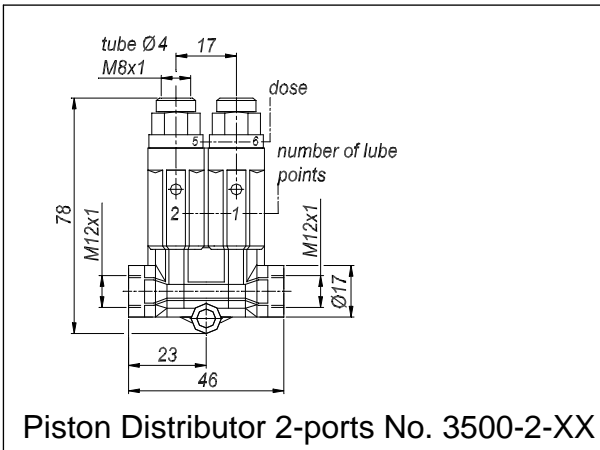

Piston Distributor 2-ports No. 3500-2-XX

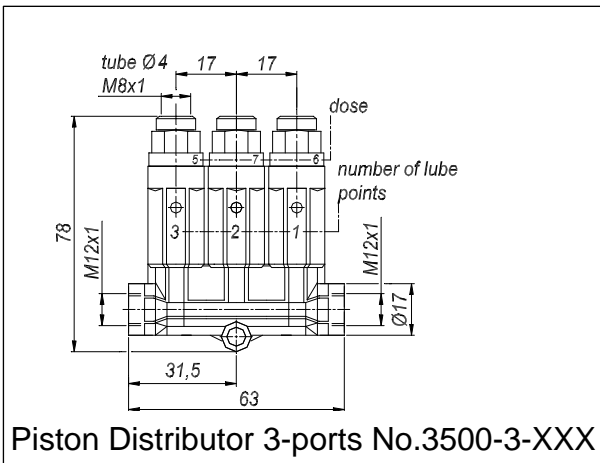

Piston Distributor 3-ports No.3500-3-XXX

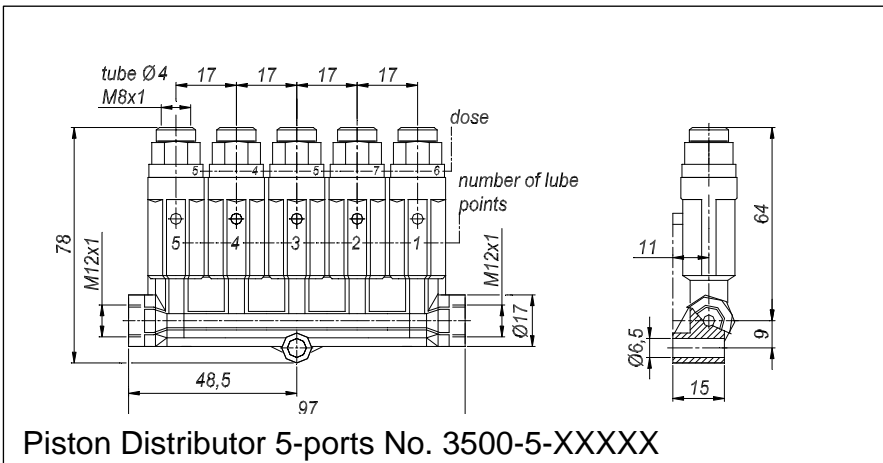

Piston Distributor 5-ports No. 3500-5-XXXXX

**Order key:**

**3500-X-XXXXX**

Number of outlets :

- 1
- 2
- 3
- 5

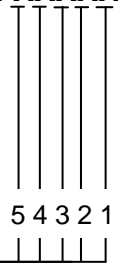

Quantity<sup>2</sup>):

- 0 – 0 cm<sup>3</sup> - outlet closed
- 4 – 0,10 cm<sup>3</sup>
- 5 – 0,20 cm<sup>3</sup>
- 6 – 0,40 cm<sup>3</sup>
- 7 – 0,60 cm<sup>3</sup>

<sup>2</sup>) marking on the metering nipple

**Order example:**

Distributor group: **3500**

with 3 outlets key: **3**

marking from the right to the left:

0,60 - 0,20 - 0,40 cm<sup>3</sup>

Order key: **7 5 6**

**Order key: 3500-3-756**

**Specifications**

- operating pressure: 10 – 45 bar
- medium: oil
- viscosity: 32 to 2000 mm<sup>2</sup>/s
- temperature range: +0°C to +70°C
- perm. residual pressure: max. 1,5 bar

**MANTA®**

**Piston Distributor for oil**  
group 3900 0,20 – 1,50 cm<sup>3</sup>

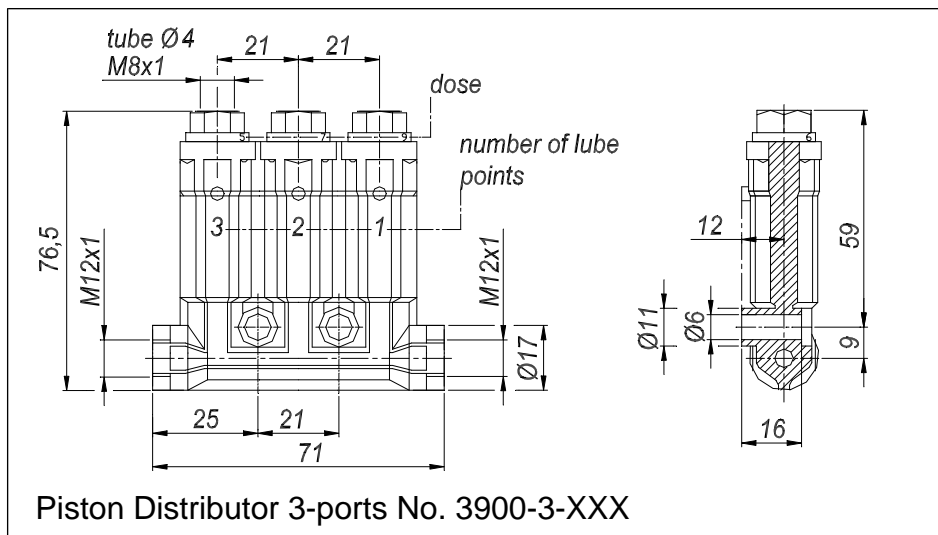
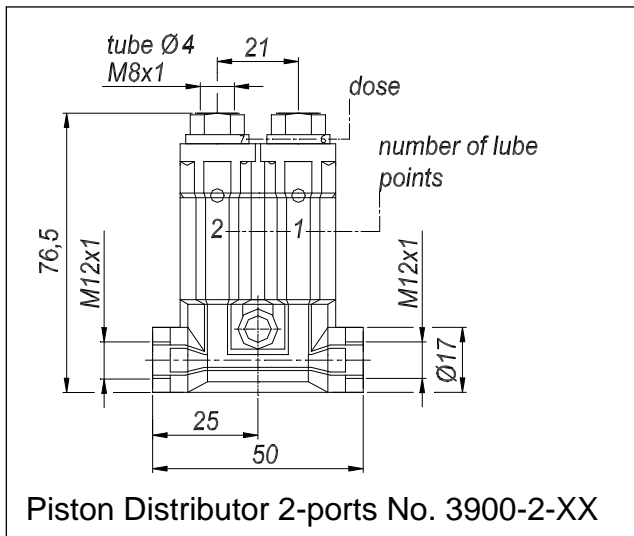
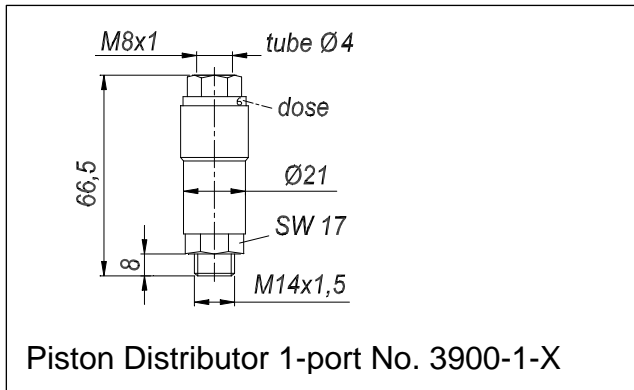

**Order key:**

**3900-X-XXXXX**

Number of outlets :



Quantity<sup>2)</sup>:

**0** – 0 cm<sup>3</sup> - outlet closed

**5** – 0,20 cm<sup>3</sup>

**6** – 0,40 cm<sup>3</sup>

**7** – 0,60 cm<sup>3</sup>

**8** – 1,00 cm<sup>3</sup>

**9** – 1,50 cm<sup>3</sup>

<sup>2)</sup>marking on the metering nipple

**Order example:**

Distributor group: **3900**

with 3 outlets key: **3**

marking from the right to the left:

0,20 – 0,60 – 1,50 cm<sup>3</sup>

Order key:

**5 7 9**

**Order key: 3900-3-579**

**Specifications**

- operating pressure: 10 – 45 bar
- medium: oil
- viscosity: 32 to 2000 mm<sup>2</sup>/s
- temperature range: +0°C to + 70°C
- perm. Residual pressure: max. 1,5 bar

**Piston Distributor for grease NLGI 000, 00**

group 3410 0,01 – 0,10 cm<sup>3</sup>

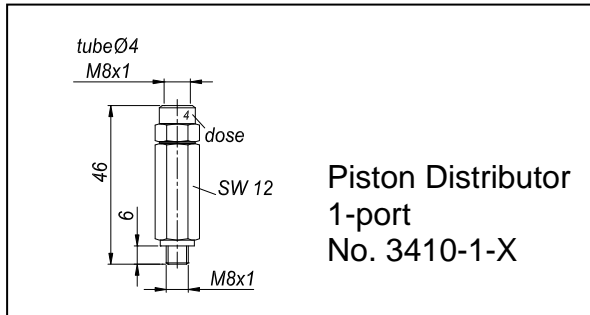

**Order key:**

**3410-X-XXXXX**

Number of outlets :

- 1
- 2
- 3
- 5

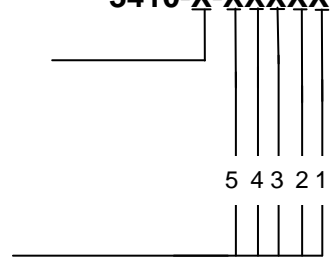

Quantity <sup>2)</sup>:

- 0 – 0 cm<sup>3</sup> - outlet closed
- 1 – 0,01 cm<sup>3</sup>
- 2 – 0,03 cm<sup>3</sup>
- 3 – 0,06 cm<sup>3</sup>
- 4 – 0,10 cm<sup>3</sup>

<sup>2)</sup> marking on the metering nipple

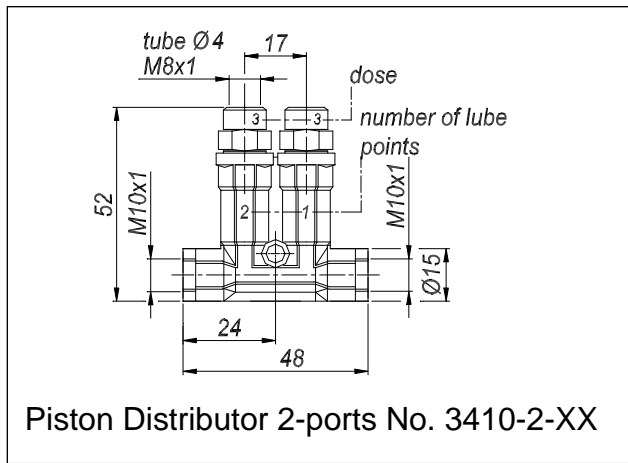

**Order example:**

Distributor group: **3410**

with 3 outlets key **3**

marking from the right to the left:

0,06 - 0,10 - 0,03 cm<sup>3</sup>

Order key:

**3 4 2**

**Order key: 3410-3-342**

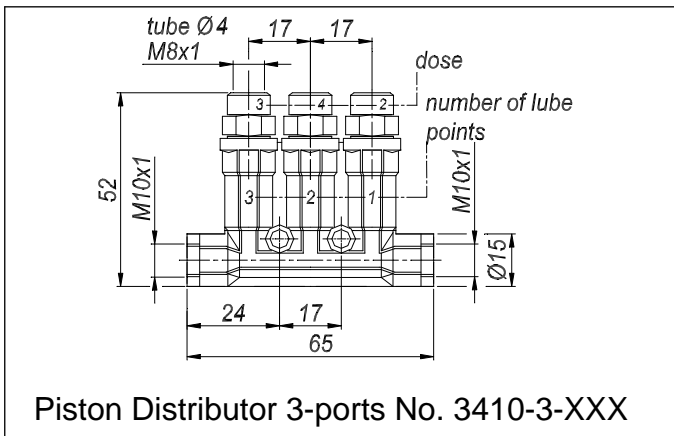

**Specifications**

- operating pressure: 10 – 45 bar
- medium: grease NLGI 000, 00
- temperature range: +0°C to + 60°C
- perm. residual pressure: max. 1,5 bar

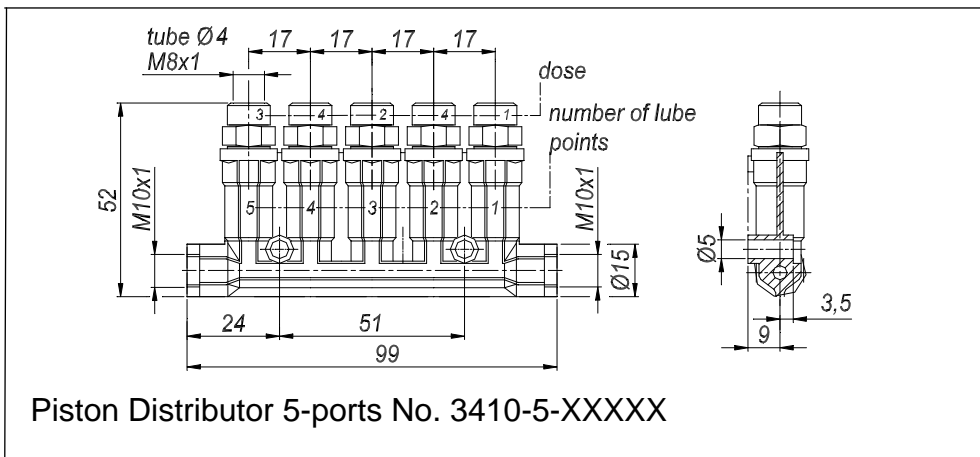

# MANTA®

## Piston Distributor for grease NLGI 000, 00

group 3510 0,10 – 0,30 cm<sup>3</sup>

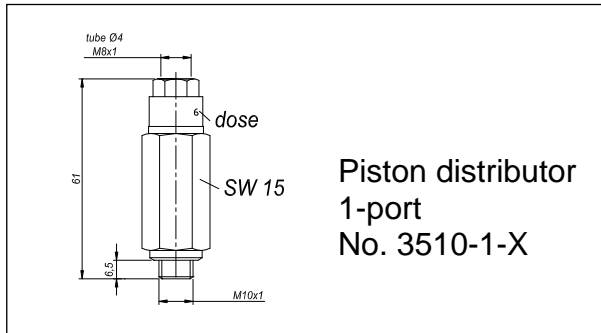

Piston distributor  
1-port  
No. 3510-1-X

Order key:

3510-X-XXXXX

Number of outlets :



Quantity<sup>2)</sup>:

0 – 0 cm<sup>3</sup> - outlet closed

4 – 0,10 cm<sup>3</sup>

5 – 0,20 cm<sup>3</sup>

6 – 0,30 cm<sup>3</sup>

<sup>2)</sup>marking on the  
metering nipple

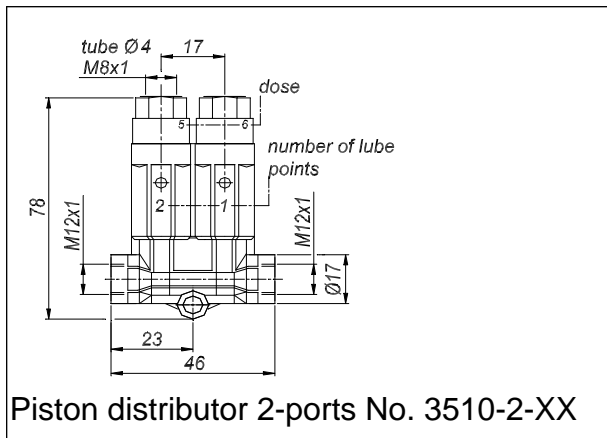

Piston distributor 2-ports No. 3510-2-XX

Order example:

Distributor group: 3510

with 3 outlets key: 3

marking from the right to the left:

0,20 - 0,10 - 0,30 cm<sup>3</sup>

Order key:

5 4 6

Order key: 3510-3-546

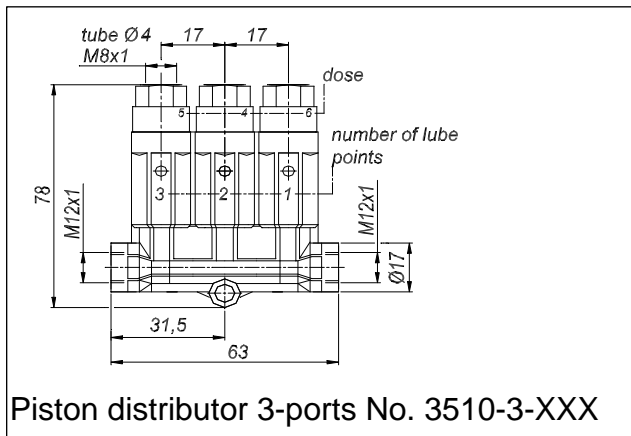

Piston distributor 3-ports No. 3510-3-XXX

### Specifications

operating pressure:

10 – 45 bar

medium:

grease NLGI 000, 00

temperature range:

+0°C to +60°C

perm. residual pressure: max. 1,5 bar

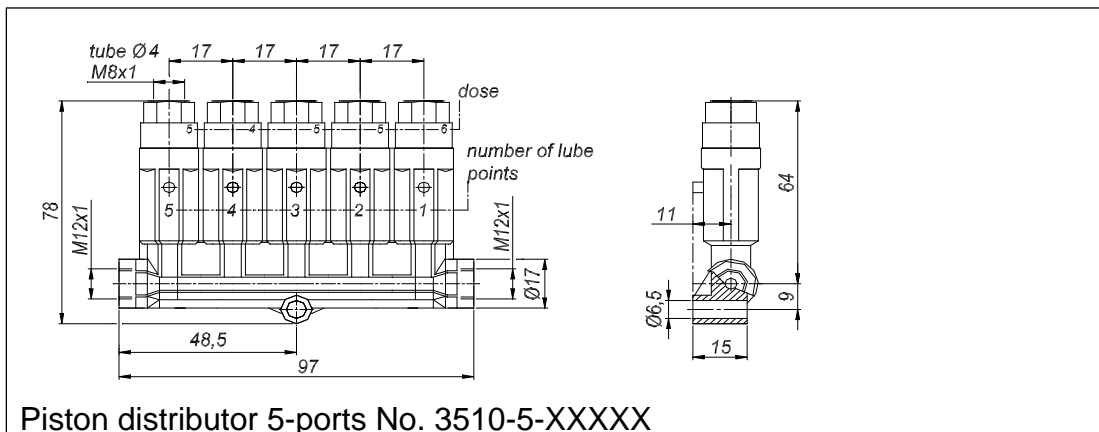

Piston distributor 5-ports No. 3510-5-XXXXX

**MANTA®**

**Piston Distributor for grease NLGI 000, 00**  
*group 3910 0,10 – 0,30 cm<sup>3</sup>*

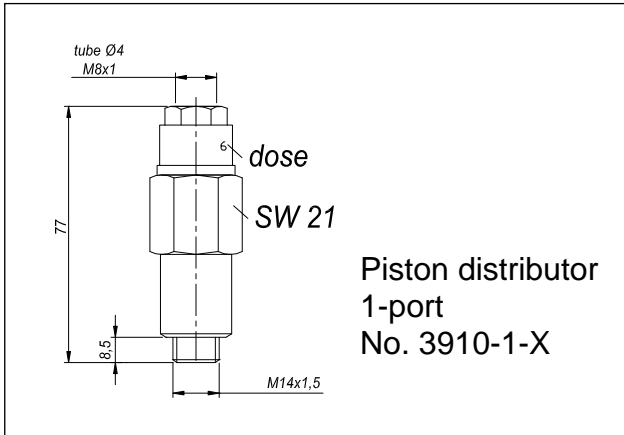

Piston distributor  
 1-port  
 No. 3910-1-X

**Order key:**

**3910-X-XXX**

Number of outlets :

- 1
- 2
- 3

3 2 1

Quantity<sup>2)</sup>:

- 0 – 0 cm<sup>3</sup> - outlet closed
- 4 – 0,10 cm<sup>3</sup>
- 5 – 0,20 cm<sup>3</sup>
- 6 – 0,30 cm<sup>3</sup>

<sup>2)</sup>marking on the  
 metering nipple

**Order example:**

Distributor group: **3910**

with 2 outlets key: **2**

marking from the right to the left:

0,20 – 0,30 cm<sup>3</sup>

Order key: **5 6**

**Order key: 3910-3-56**

**Specifications**

operating pressure: 10 – 45 bar  
 medium: grease NLGI 000, 00  
 temperature range: 0°C to + 60°C  
 perm. residual pressure: max. 1,5 bar

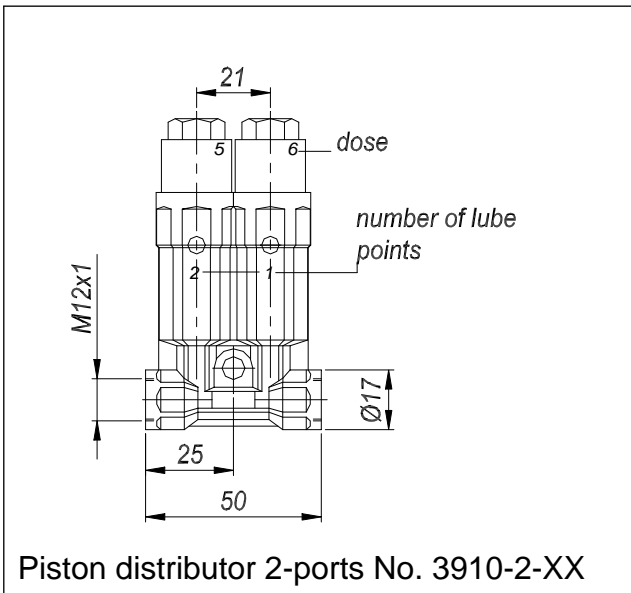

Piston distributor 2-ports No. 3910-2-XX

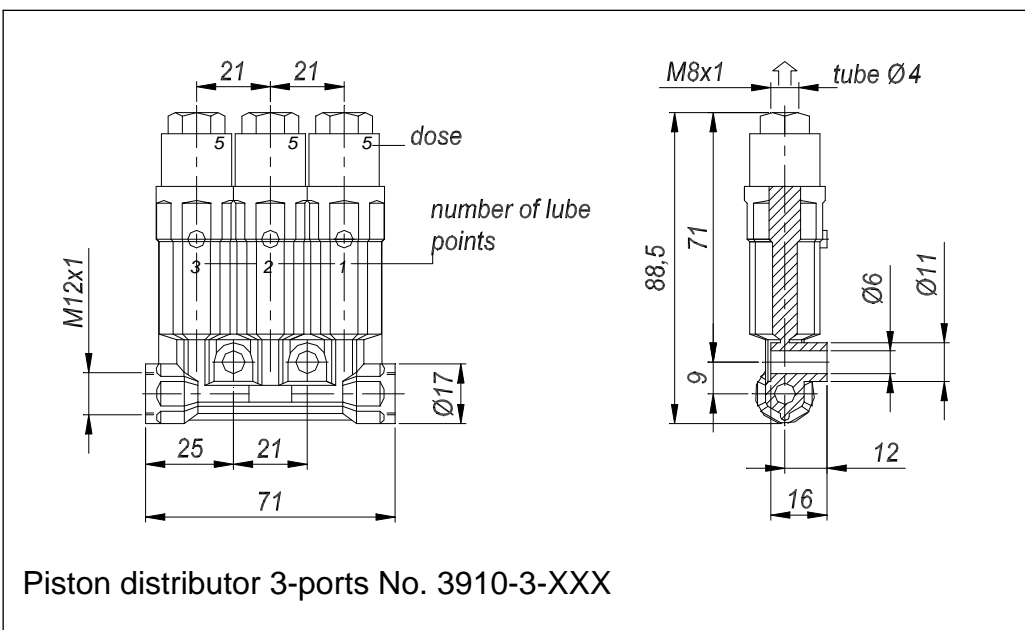

Piston distributor 3-ports No. 3910-3-XXX



**MANTA®**

**Metering units for direct connection to the lube point**

**For oil and grease NLGI 000, 00**

*group KVF- 3210*

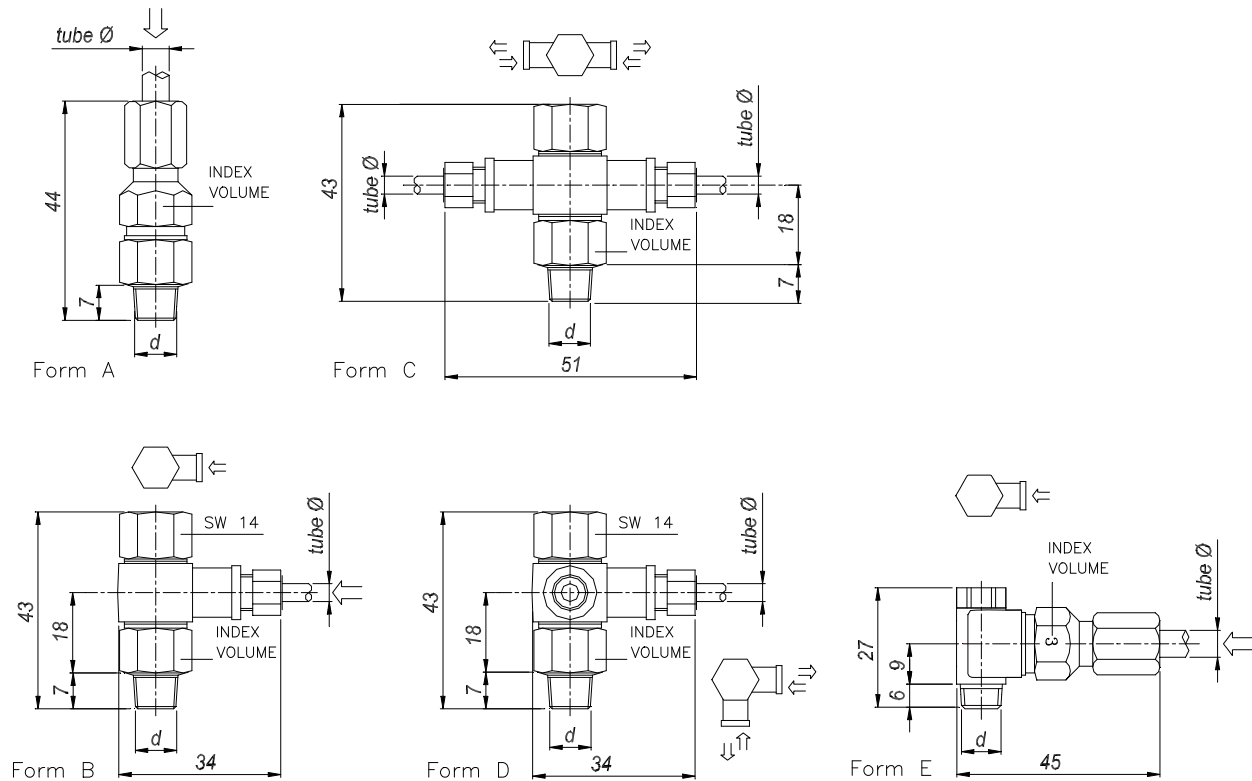

**Order key:**

**KVF 3210 X-X-X-X**

Form	Tube Ø	Quantity	d
A - Form A	4 - Ø 4 only for oil	2 - 0,03 cm <sup>3</sup>	1 - M8x1K
B - Form B	6 - Ø 6	3 - 0,06 cm <sup>3</sup>	2 - M10x1K
C - Form C		4 - 0,10 cm <sup>3</sup>	3 - G1/8"K
D - Form D			
E - Form E			

**Example:**

Metering units group: **3210**  
 Form A : **A**  
 screws for 6 mm tube: **6**  
 quantity 0,10 cm<sup>3</sup>: **4**  
 d - M10x1 K: **2**  
**Order key: 3210-A-6-4-2**

**Specifications**

operating pressure: 18 – 50 bar  
 medium: oil and grease  
 NLGI 000, 00  
 temperature range: 0°C to + 70°C  
 perm. residual pressure: max. 3 bar

**MANTA®**

**Metering units for direct connection to the lube point**

**For oil and grease NLGI 000, 00**

*group KVF- 3210*

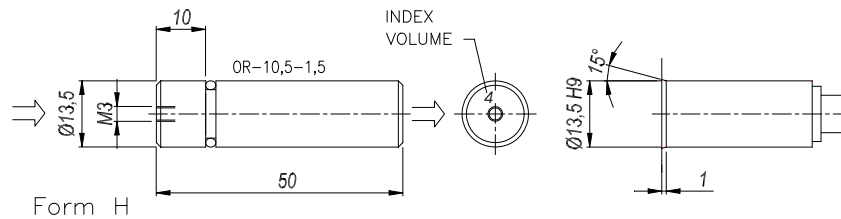
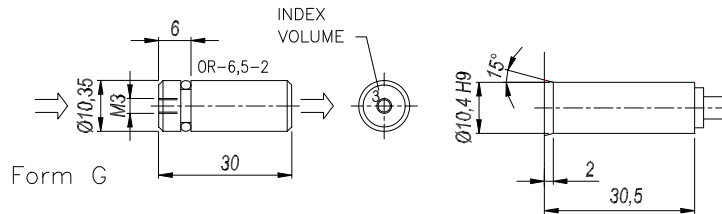
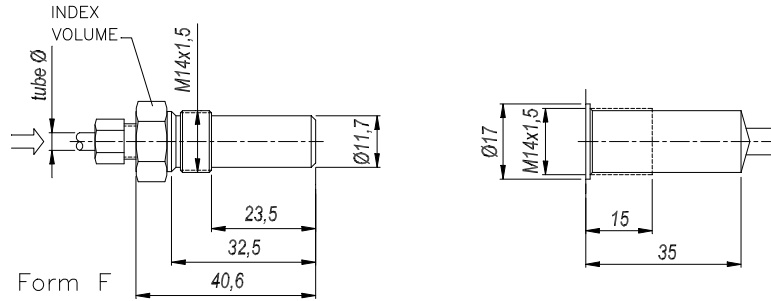

**Order key: KVF 3210 X-X-X**

Form	Tube Ø	Quantity
Form F - <b>F</b>	4 - Ø 4 only for oil 6 - Ø 6	2 - 0,03 cm <sup>3</sup> 3 - 0,06 cm <sup>3</sup> 4 - 0,10 cm <sup>3</sup>
Form G - <b>G</b>		
Form H - <b>H</b>		4 - 0,10 cm <sup>3</sup> 5 - 0,20 cm <sup>3</sup> 6 - 0,40 cm <sup>3</sup>

**Example:**

Metering units group: **3210**  
 Form F : **F**  
 screws for 6 mm tube: **6**  
 quantity 0,10 cm<sup>3</sup>: **4**  
**Order key: 3210-F-6-4**

**Specifications**

operating pressure: 18 – 50 bar  
 medium: oil and grease NLGI 000, 00  
 Temperature range: 0°C to + 70°C  
 perm. residual pressure: max. 3 bar

# MANTA®

## Piston Pump for oil and grease hand operated Type EHP

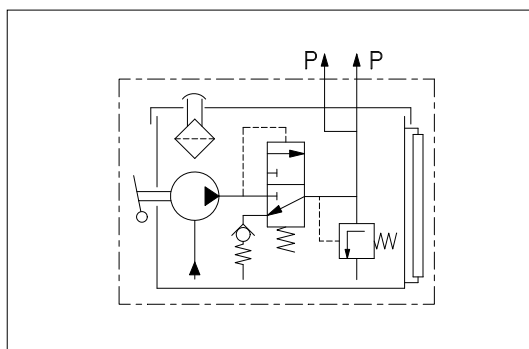
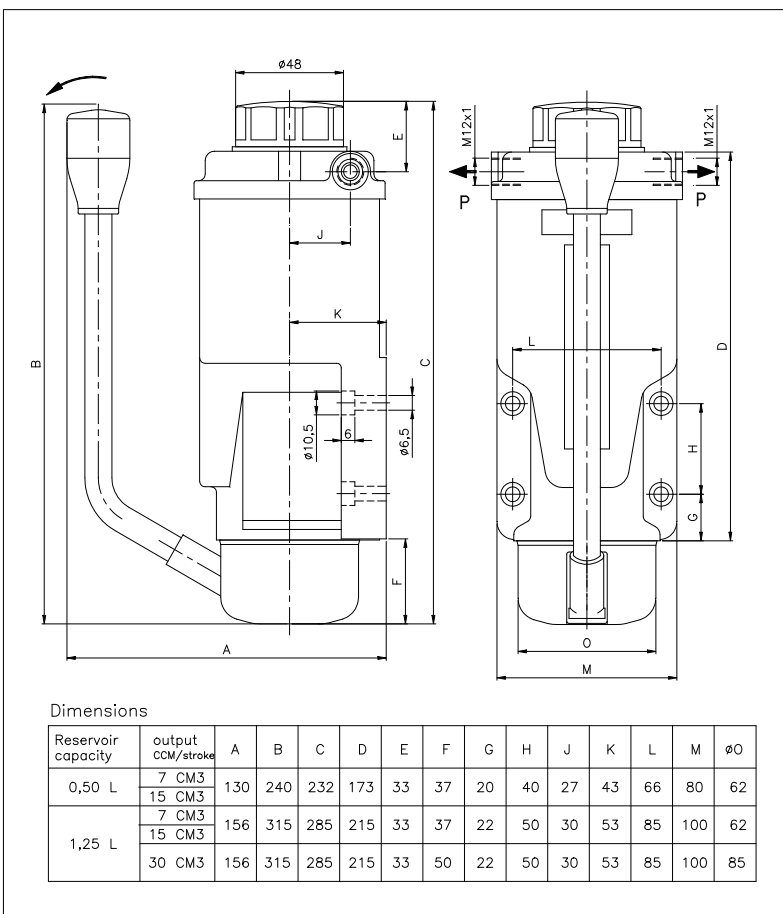

### Specifications

#### Hand operated pump

Output per stroke: 7, 15 or 30 cm<sup>3</sup>  
 pressure max.: 30 bar  
 perm residual pressure: 0,5 to 1 bar  
 medium: oil  
 viscosity: 20 to 3000 mm<sup>2</sup>/s (cSt)  
 operating temperature: -10°C to + 80°C  
 reset valve: 25 bar

#### Reservoir

Capacity: 0,5 or 1,25 Litres  
 Material: Aluminium  
 Oil indicator: optical

### Order key:

**EHP-X-X-X**

Capacity	Output per stroke	Reset valve
5 – 0,5 Litres	1 – 7 cm <sup>3</sup>	0 - without
6 – 1,25 Litres	2 – 15 cm <sup>3</sup>	5 - with reset valve
6 – 1,25 Litres	3 – 30 cm <sup>3</sup>	0 - without
		5 - with reset valve

### Example:

hand operated pump Type: **EHP**  
 capacity 1,25 Litres: **6**  
 output 7 cm<sup>3</sup>/stroke: **1**  
 with reset valve: **5**

Order key: **EHP-6-1-5**

# MANTA®

## Gear pump for oil Type EPA

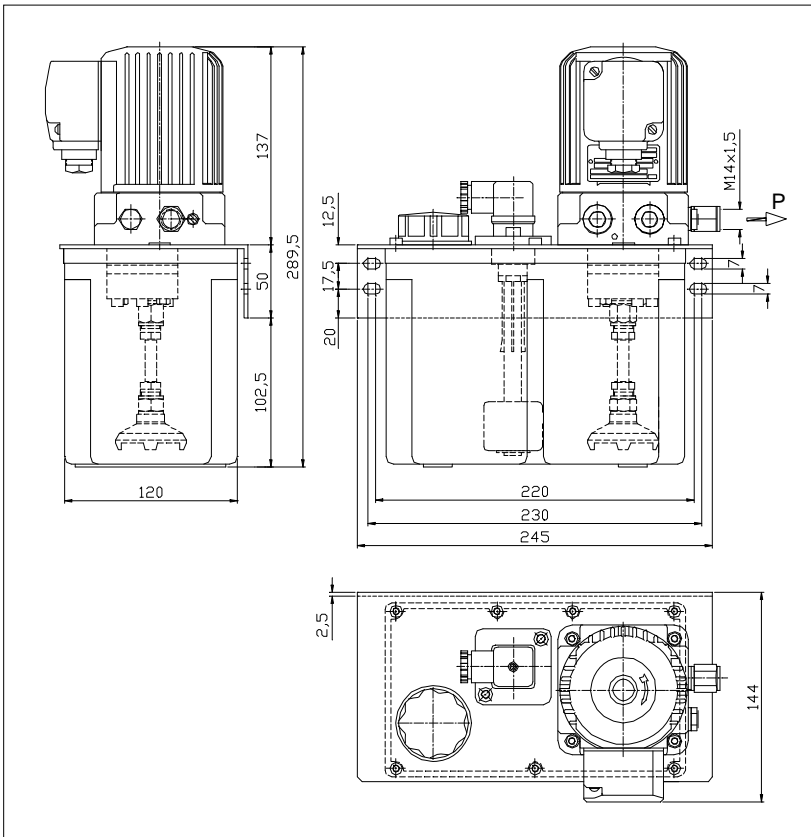

Illustrated: EPA-3 Gearpump  
3 l Capacity.

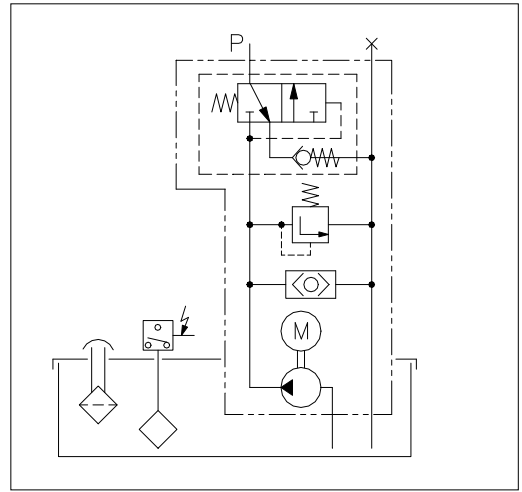

### Specifications

#### Pump

Discharge: 0,2 or 0,5 l/min  
 Pressure: max.: 30 bar  
 medium: oil  
 viscosity: 50 to 1500 mm<sup>2</sup>/s (cSt)  
 operating temperature: max. 60°C

#### Reservoir

Capacity: 3 or 6 Litres  
 Material: Plastic, transparent

#### Motor

Voltage:  
 3 ph 230/400V 50Hz 0,66/0,38A  
 3 ph 276/480V 60Hz 0,75/0,43A  
 Power rating: 70 W  
 Speed: 50Hz:2730/60Hz:3200 min<sup>-1</sup>  
 Type of enclosure: IP-44

### Order key:

**EPA-X-X-X-X**

Capacity	Discharge	Float switch	Voltage
3 - 3 Litres 6 - 6 Litres	2 - 0,2 l/min 5 - 0,5 l/min	0 - none 5 - „min“ 6 - „min“ and „max“	3 - 230/400V 50Hz 276/480V 60Hz

Float switch  
 voltage max.: 250V AC  
 Power max. 0,8A

Circuit diagram:

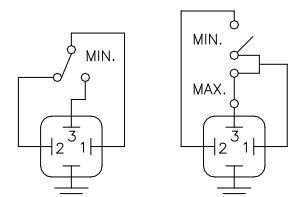

### Example:

Pump Type: **EPA**  
 Capacity 3 Litres: **3**  
 Discharge 0,2 l/min: **2**  
 Float switch „min“: **5**  
 Motor 230/400 V: **3**  
**Order key: EPA-3-2-5-3**

# MANTA®

## Gear pump for oil Type EPA

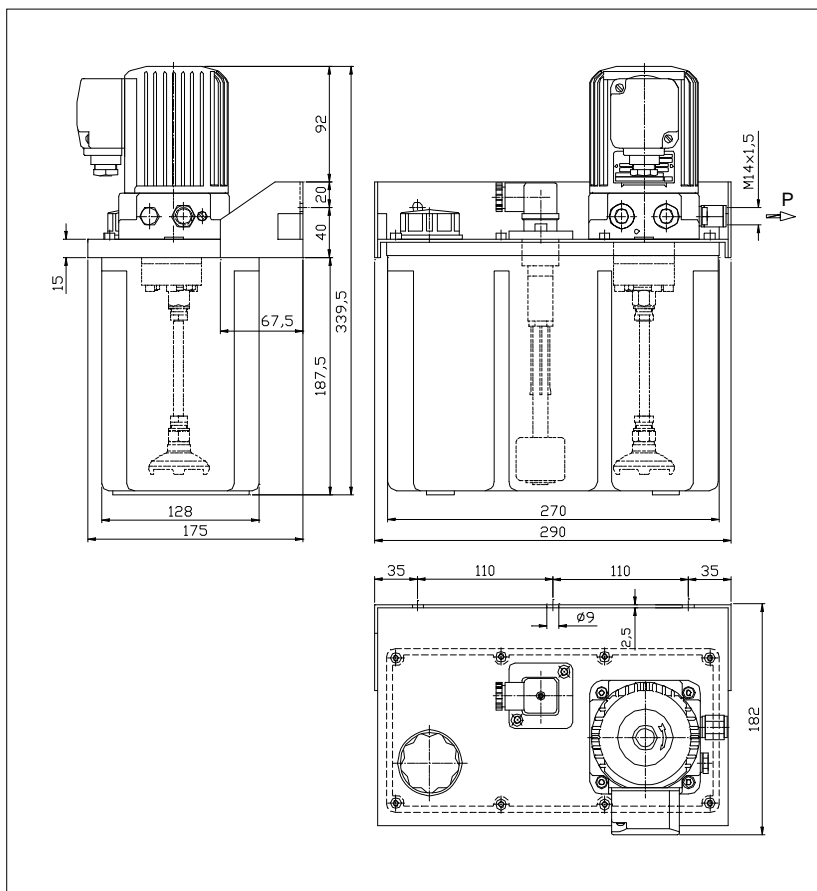

Illustrated: EPA Gearpump  
6 l Capacity

### Hydraulic diagram

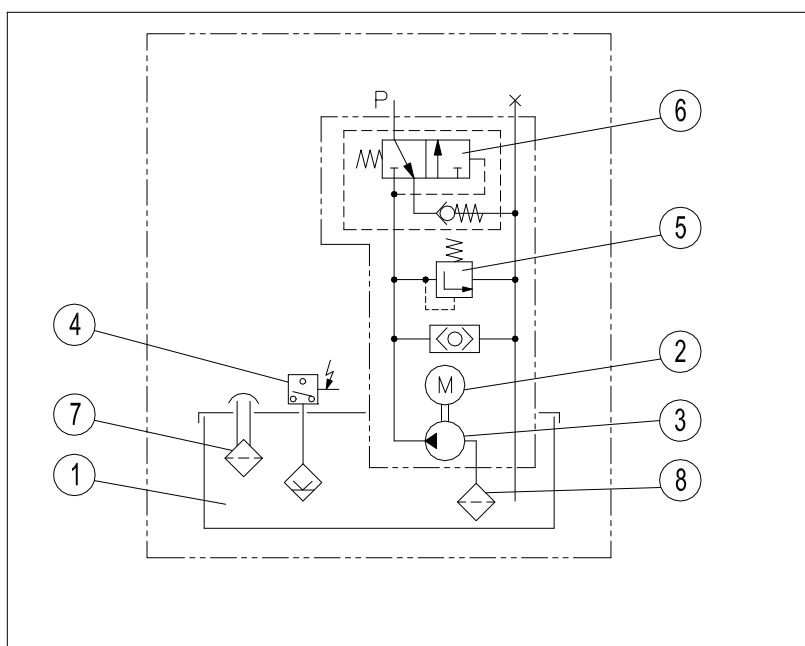

### Specifications

#### Pump

Discharge: 0,2 or 0,5 l/min  
 Pressure: max.: 30 bar  
 medium: oil  
 viscosity: 50 to 1500 mm<sup>2</sup>/s (cSt)  
 operating temperature: max. 60°C

#### Reservoir

Capacity: 3 or 6 Litres  
 Material: Plastic, transparent

#### Motor

Voltage:  
 3 ph 230/400V 50Hz 0,66/0,38A  
 3 ph 276/480V 60Hz 0,75/0,43A  
 Power rating: 70 W  
 Speed: 50Hz:2730/60Hz:3200 min<sup>-1</sup>  
 Type of enclosure: IP-44

### Float switch

voltage max.: 250V AC  
 Power max. 0,8A

### Circuit diagram:

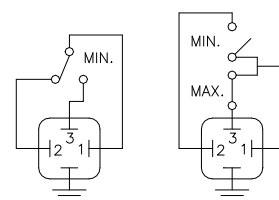

1. reservoir
2. motor
3. gear pump
4. low level switch
5. pressure control valve
6. relief valve
7. fill filter
8. suction filter

# MANTA®

## Gear pump for oil Type EPA-A without tank

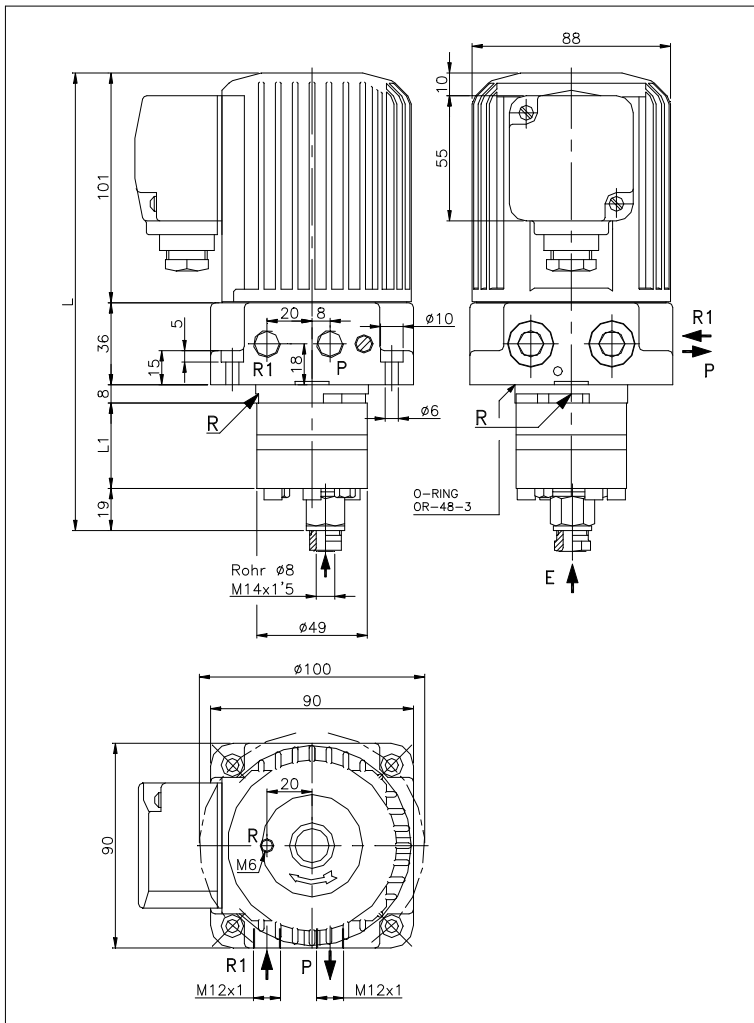

Discharge	L	L1
0,2 l/min	197	34
0,5 l/min	201	38

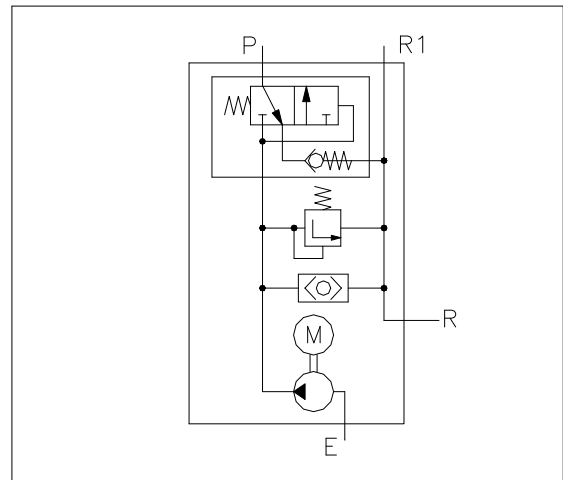

### Specifications

#### Pump

Discharge: 0,2 or 0,5 l/min  
 pressure max.: 30 bar  
 medium: oil  
 Viscosity: 50 to 1500 mm<sup>2</sup>/s (cSt)  
 Operating temperature: max. 60°C  
 Suction height: max. 500 mm  
 remaining pressure: 0,4 to 1,6 bar

#### Motor

Voltage:  
 3 ph 230/400V 50Hz 0,66/0,38A  
 3 ph 276/480V 60Hz 0,75/0,43A  
 Power: 70 W  
 Speed: 50Hz:2730/60Hz:3200 min<sup>-1</sup>  
 Protection: IP-44

P = output  
 E = input  
 R = return directly to tank  
 R1 = alternative return

Order key: EPA-A-X-X-X

Type	Discharge	Voltage
0 – separate mounting 2 – mounting on a tank	2 - 0,2 l/min 5 - 0,5 l/min	3 - 3 ph 230/400V 276/480V

### Example:

Pump Type: EPA-A  
 Mounting on a tank/ reservoir: 2  
 discharge 0,2 l/min: 2  
 motor: 3

Order key: EPA-A-2-2-3

# MANTA®

## Gear pump for grease Type EPA-F

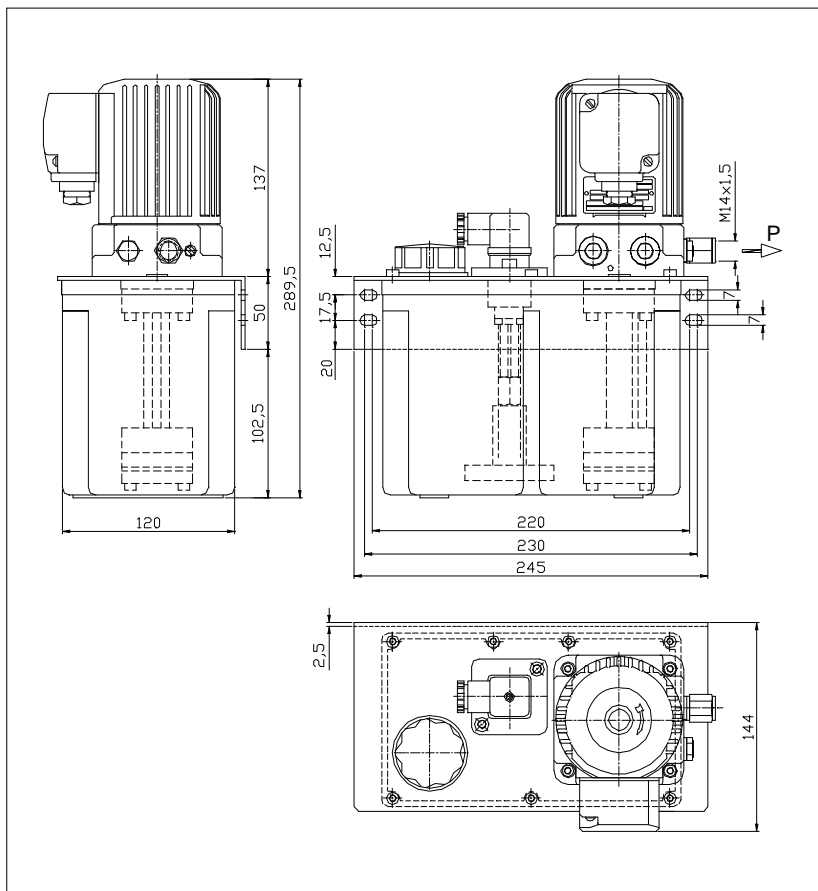

Illustrated: EPA-F-3 Pump  
With 3 litres reservoir.

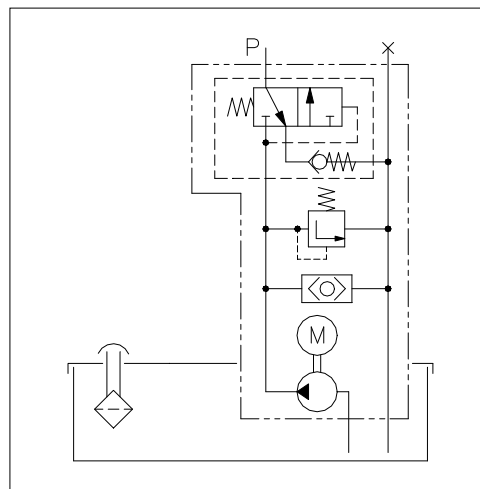

### Specifications

#### Pump

Discharge: 0,2 l/min  
 pressure, max.: 40 bar  
 medium: grease,  
 NLGI-Class 000, 00  
 Operating temperature: max. 60°C

#### Reservoir

Capacity: 3 or 6 Litres  
 Material: Plastic, transparent

#### Three phase current motor

Voltage:  
 3 ph 230/400V 50Hz 0,66/0,38A  
 3 ph 276/480V 60Hz 0,75/0,43A  
 Power: 70 W  
 Speed: 50Hz:2730/60Hz:3200 min<sup>-1</sup>  
 Protection: IP-44

### Order key:

EPA-F-X-X-X

Capacity	Discharge	level switch
3 - 3 Litres 6 - 6 Litres	2 - 0,2 l/min	0 – none 5 – „min“

#### level switch

Voltage max.: 250V AC  
 Switch voltage max. 0,8A

### Example:

Pump Type: **EPA-F**  
 Capacity: 3 Litres: **3**  
 Discharge: 0,2 l/min: **2**  
 Level switch: **5**

Order key: **EPA-F-3-2-5**

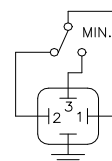

**MANTA®**  
Manifolds

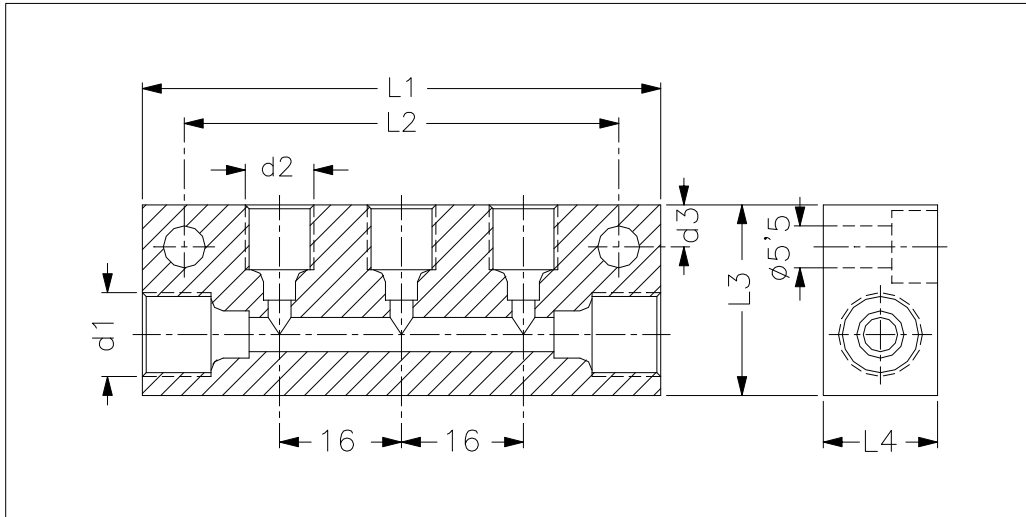

Tube $\varnothing$ d	d1	d2	d3	L1	L2	L3	L4	Order No.
6 – 4	M10x1	1x M8x1	5,5	35	24	25	15	6721
6 – 4	M10x1	2x M8x1	5,5	52	41	25	15	6722
6 – 4	M10x1	3x M8x1	5,5	68	57	25	15	6723
6 – 4	M10x1	4x M8x1	5,5	84	73	25	15	6724
6 – 4	M10x1	5x M8x1	5,5	100	89	25	15	6725
6 – 4	M10x1	6x M8x1	5,5	116	105	25	15	6726
6 – 4	M10x1	7x M8x1	5,5	132	121	25	15	6727
6 – 4	M10x1	8x M8x1	5,5	148	137	25	15	6728
8 – 4	M12x1	1x M8x1	5,5	35	24	25	15	6731
8 – 4	M12x1	2x M8x1	5,5	52	41	25	15	6732
8 – 4	M12x1	3x M8x1	5,5	68	57	25	15	6733
8 – 4	M12x1	4x M8x1	5,5	84	73	25	15	6734
8 – 4	M12x1	5x M8x1	5,5	100	89	25	15	6735
8 – 4	M12x1	6x M8x1	5,5	116	105	25	15	6736
8 – 4	M12x1	7x M8x1	5,5	132	121	25	15	6737
8 – 4	M12x1	8x M8x1	5,5	148	137	25	15	6738



# MANTA® Manifolds

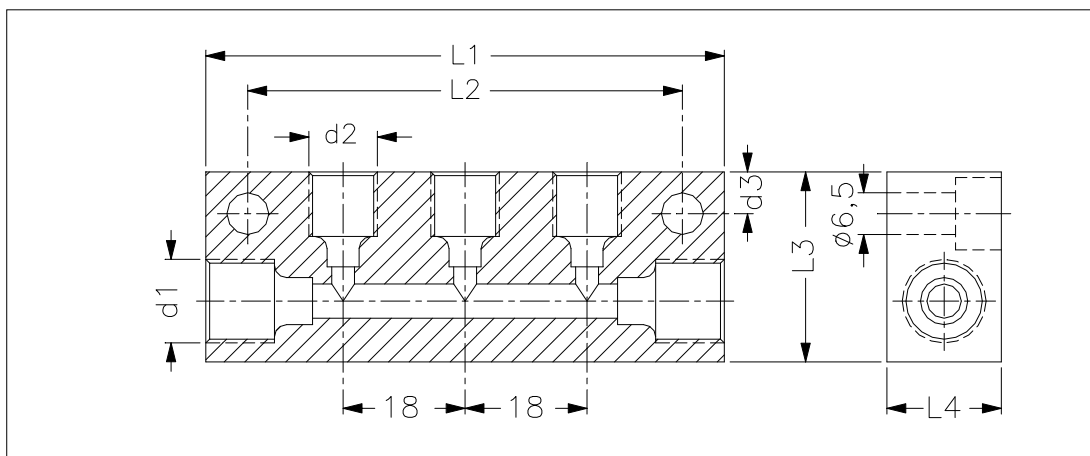

Tube ø d	d1	d2	d3	L1	L2	L3	L4	Order No.
6 – 6	M10x1	1x M10x1	5,5	35	24	25	15	6781
6 – 6	M10x1	2x M10x1	5,5	53	42	25	15	6782
6 – 6	M10x1	3x M10x1	5,5	71	60	25	15	6783
6 – 6	M10x1	4x M10x1	5,5	89	78	25	15	6784
6 – 6	M10x1	5x M10x1	5,5	107	96	25	15	6785
6 – 6	M10x1	6x M10x1	5,5	125	114	25	15	6786
6 – 6	M10x1	7x M10x1	5,5	143	132	25	15	6787
6 – 6	M10x1	8x M10x1	5,5	161	143	25	15	6788
8 – 6	M14x1,5	2x M10x1	6,5	67	50	30	20	6742
8 – 6	M14x1,5	3x M10x1	6,5	85	68	30	20	6743
8 – 6	M14x1,5	4x M10x1	6,5	103	86	30	20	6744
8 – 6	M14x1,5	5x M10x1	6,5	121	104	30	20	6745
8 – 6	M14x1,5	6x M10x1	6,5	139	122	30	20	6746
8 – 6	M14x1,5	7x M10x1	6,5	157	140	30	20	6747
8 – 6	M14x1,5	8x M10x1	6,5	175	158	30	20	6748

T-Unit – for mounting a separate metering unit	D1	D2	D3	L1	L2	L3	Order No.
	M8x1	M8x1	14	32	36	15	6281
	M10x1	M10x1	14	32	36	15	6282
	M14x1,5	M14x1,5	18	36	44	20	6283
	M12x1	M12x1	18	36	44	20	6284
	M14x1,5	M10x1	18	36	44	20	6285

**MANTA®**  
**Manifolds**

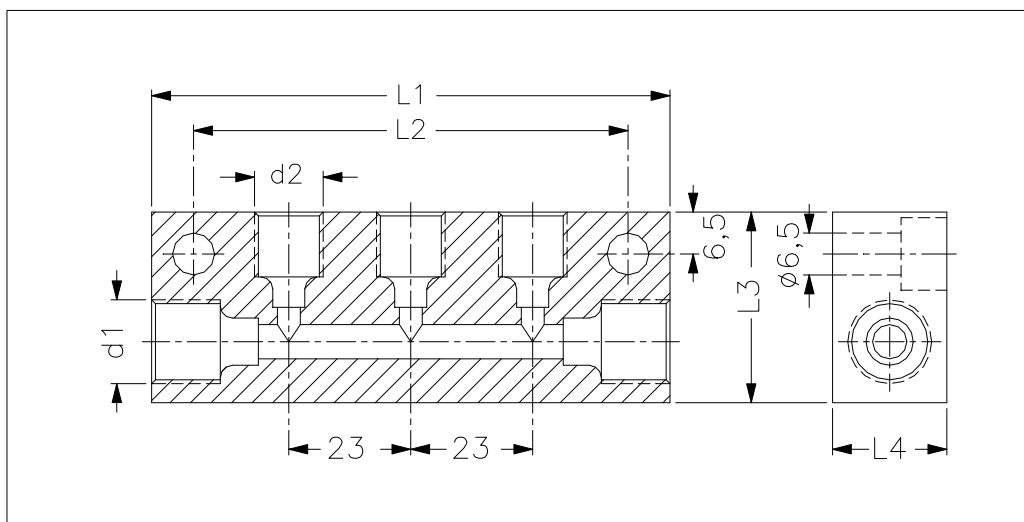

Tube $\varnothing$ d	d1	d2	L1	L2	L3	L4	Order No.
8 – 8	M14x1,5	1x M14x1,5	49	32	35	20	6751
8 – 8	M14x1,5	2x M12x1	72	55	30	20	6752
8 – 8	M14x1,5	3x M12x1	95	78	30	20	6753
8 – 8	M14x1,5	4x M12x1	118	101	30	20	6754
8 – 8	M14x1,5	5x M12x1	147	130	30	20	6755
8 – 8	M14x1,5	6x M12x1	164	147	30	20	6756
8 – 8	M14x1,5	7x M12x1	187	170	30	20	6757
8 – 8	M14x1,5	8x M12x1	210	193	30	20	6758
10 – 10	M16x1,5	1x M16x1,5	49	32	35	20	6761
10 – 8	M16x1,5	2x M14x1,5	72	55	35	20	6762
10 – 8	M16x1,5	3x M14x1,5	95	78	35	20	6763
10 – 8	M16x1,5	4x M14x1,5	118	101	35	20	6764
10 – 8	M16x1,5	5x M14x1,5	147	130	35	20	6765
10 – 8	M16x1,5	6x M14x1,5	164	147	35	20	6766

**Piston Distributor– Accessoires**

For main line and lube line fittings  
Distributor fittings and screw caps

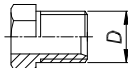
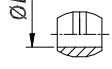
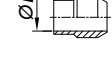
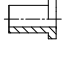
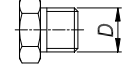
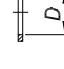
		Description	Thread D	For tube Ø	Order No.
		Wrap screw for double tapered ring	M8x1 M10x1 M12x1 M14x1,5	4 6 8 8	6212 6213 6214 6215
		Wrap screw for cone ring	M8x1 M10x1	4 6	6216 6217
Main line and lube line fittings for steel tubing		Double tapered ring		4 6 8 10 12	6222 6223 6224 6225 6226
Main line- and lube line fittings for plastic tubing		Cone ring		4 6 8 10 12	6232 6233 6234 6235 6236
		Case		4x0,85 4x1,5 4x1,3 4x1 6x1 6x1,25 8x1 8x1,5 10x1,5 10x2	6241 6242 6243 6244 6245 6246 6247 6248 6249 6250
		Screw plug	M8x1 M10x1 M12x1 M14x1,5		6252 6253 6254 6255
		Washer	8,2 10,2 12,2 14,2		6262 6263 6264 6260

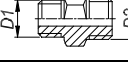
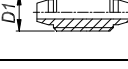
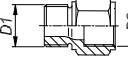
		Description	Thread D 1	Thread D 2	Order No.
		Thread to distributor	M10x1 M12x1 M10x1	M12x1 M14x1,5 M10x1	6064 6065 6066
			M10x1 M12x1 M14x1,5		6067 6068 6069
			M10x1		6070
Self-sealing			M10x1		6070
		Adapter	M10x1 M8x1 M10x1 M12x1 M14x1,5	M8x1 M10x1 M10x1 M10x1 M10x1	6270 6271 6272 6273 6274
			M10x1 M12x1 M14x1,5	M12x1 M12x1 M12x1	6275 6276 6277
			M10x1 M10x1 M12x1	1/8"G 1/4"G 1/4"G	6278 6279 6280
			1/4"G	M14x1,5	6290



Pressure switches  
24V DC  
Adjustment range:  
10 – 50 bar  
Thread: M10x1  
Order No. 2703

## Function

1. The amount of oil intended for the lube point is stored in front of the piston in the distributor.
2. When the central lubrication pump starts delivering oil, the piston moves and the oil in front of it is fed to the lube point at a main line pressure of 10-45 bars.
3. After the pressure is relieved in the main line the distributor's piston returns to its initial position and once again lets a certain quantity of oil flow into the space in front of it.

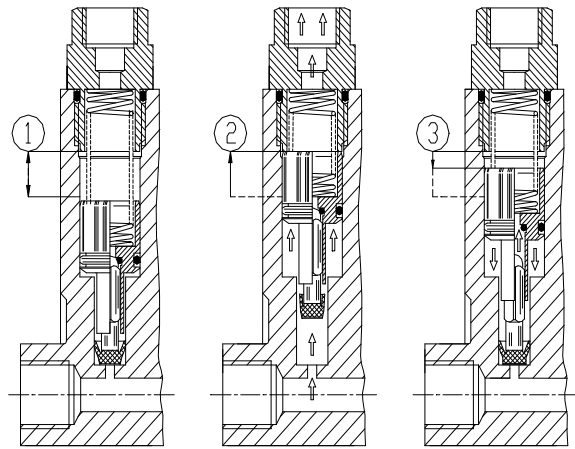

Distributor group 3200



Distributor group 3400



Distributor group 3500 and 3900

# Single-line lubrication system with piston distributor for oil

## Function

A pump feeds the lubricant through the main line to the piston distributors. From there it is directed to the lube points in precisely metered quantities. This takes place in a time- or pulse-controlled sequence.

## Planning

1. Determine the type of drive to be used for the oil pump (manual, electric for three-phase current or AC, pneumatic).
2. Select the lubricant. Then determine the pump unit and type of distributors.
3. Determine the number of lube points and define the amount of lubricant required to meet the needs of each point. Ascertain the total amount of lubricant needed per unit of time or clock pulse. Then dimension the contents of the lubricant reservoir.

## Choice of distributors

Select the piston distributors on the basis of the metered quantity and spatial constraints. The ratio of the metered quantities in respect to each other should be the same as the consumption of the individual lube points. The total amount needed by the installation is then regulated by the number of lube cycles per unit of time.

## Laying an installation

When installing a central lubrication system, lay the main lines and distributors in such a way that any air in the system can escape on its own via the lube points.

To do so, mount the distributors at appropriate places and **at the end of the installation** in such a way that the connections to the lube points **point upward** (cf. Fig. 1). The main lines from the pump to the distributors must, if possible, be laid with a **rising gradient**. If lines have to be routed to distributors at lower locations, proceed in accordance with Fig. 2.

Check the main-line resistance values, especially in regard to the relief routine, when specially large systems and ones with a large number of branches are involved or when highly viscous oils are used.

Each distributor port may be connected to only **one** lube point!

Do not connect the secondary line (connection: distributor – lube point) to the lube point until bubble-free oil emerges at its end after repeated actuation of the pump. It might be necessary to fill long secondary lines with oil first.

If a secondary line is blocked or broken, that will have no effect on the remaining lube points in the system.

